

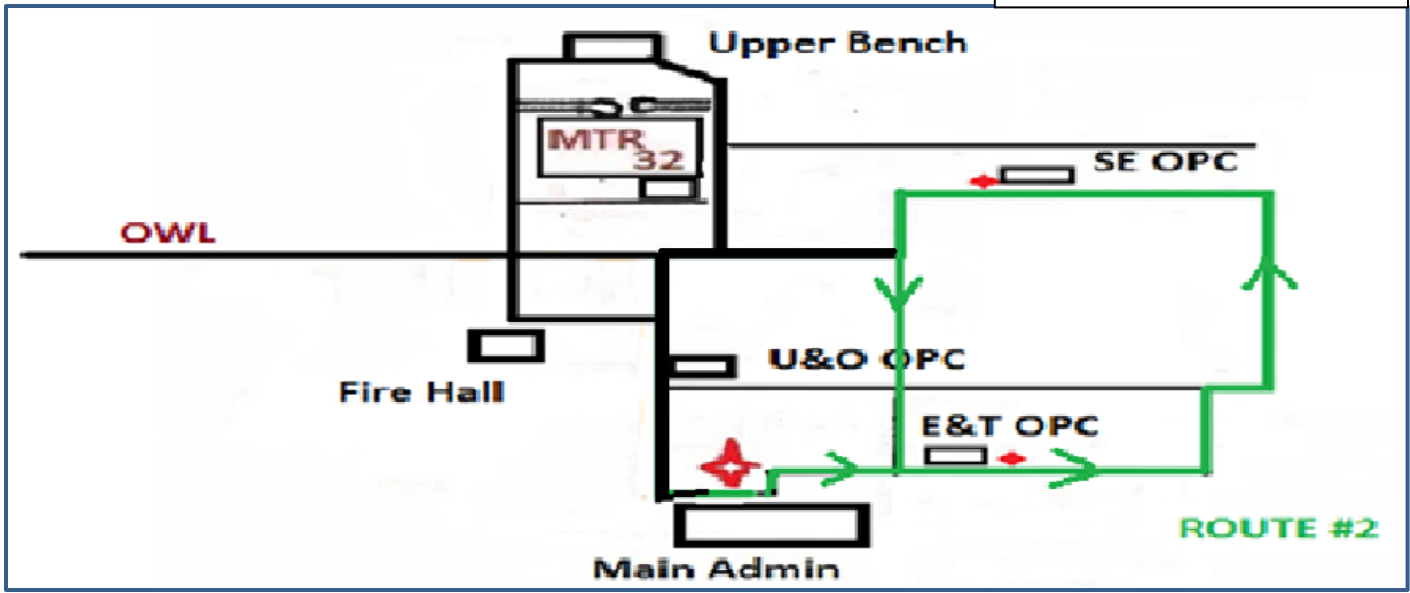

FORT HILLS OPERATIONS

ROUTE 2

Effective: 16 January 2018



| Main Admin AM Departure Times | Main Admin PM Departures Times |
|----------------------------------|-----------------------------------|
| 5:20 | 16:40 |
| 5:30 | 16:50 |
| 5:40 | 17:00 |
| 5:50 | 17:10 |
| 6:00 | 17:20 |
| 6:10 | 17:30 |
| 6:20 | 17:40 |
| 6:30 | 17:50 |
| 6:40 | 18:00 |
| 6:50 | 18:10 |
| 7:00 | 18:20 |
| 7:10 | 18:30 |
| 7:20 | 18:40 |
| | 18:50 |
| | 19:00 |
| | 19:10 |
| | 19:20 |

*17:30 No service to Sec Ext due to curfew

ROUTE DETAILS

Route No. 2

Stops:
Main Admin
028 E&T OPC
040 E&T 3
030 SEC EXT OPC
Main Admin

Frequency:
Every 10 Minutes

Bus Sign: Route 2